

GCMINI.COM

GAMECRAFT MINIATURES

GameCraft Miniatures Tournament Tray Assembly Diagram

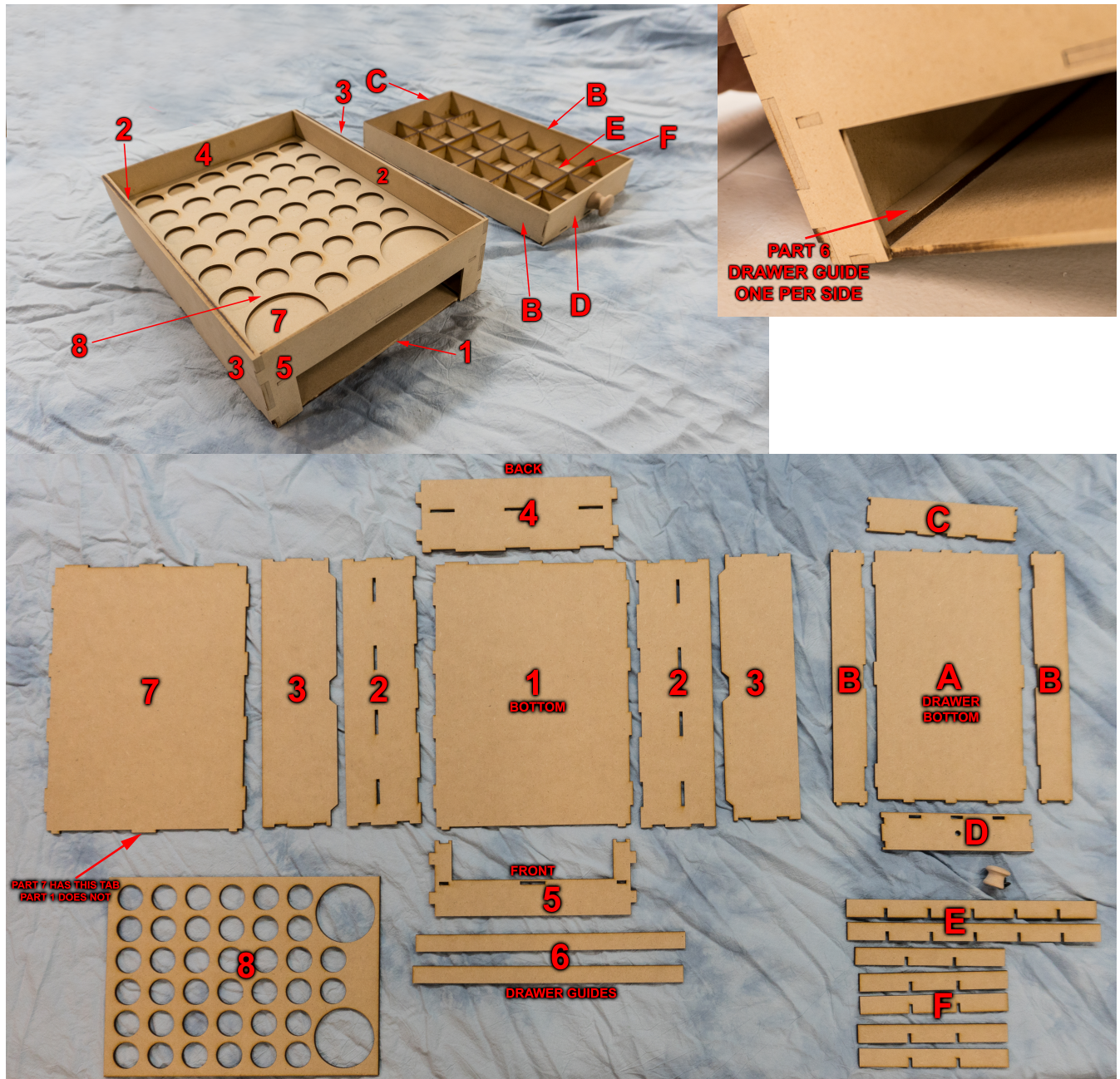

GCmini recommends assembly with wood glue or white glue.
 Dry fit all parts first to make sure you have everything right before gluing anything.
 If you have any questions about assembling the Tournament Tray
 please email us directly at help@gcmini.com,
 or phone us at 760-363-2007